



# INSTALLATION INSTRUCTIONS

## Product

7160-0356 - 0-90 CLEVIS WITH 4" ARM  
7160-0357 - LOWER CLAM SHELL MOUNT  
7160-0366 - CLAMSHELL AND 0-90 CLEVIS WITH SMALL PLATE  
7160-0367 - CLAMSHELL AND 0-90 CLEVIS WITH LARGE PLATE  
7160-0368 - EXTENDED OVERHEAD GAURD MOUNT WITH 0-90 CLEVIS  
7160-0370 - LOWER CLA SHELL MOUNT WITH LARGE BACK PLATE  
7160-0371 - SECONDARY CLAM SHELL  
7160-0420 - 0-90 CLEVIS WITH 4" ARM AND SMALL PLATE  
7160-0421 - 0-90 CLEVIS WITH 4" ARM AND LARGE PLATE  
7160-0585 - SHORT OVERHEAD GAURD WITH 0-90 CLEVIS  
7160-0586 - SHORT OVERHEAD GAURD WITH CLAMSHELL AND 0-90 CLEVIS

## Revision

REV. H

## Form

INST-541

Printing Spec: PS-001

The following instruction sheet is for mounting the part numbers listed above. These mounts are designed to attach to the pillars and roof racks of various fork trucks.

**Mounting the clam shell assembly to the pillar:  
7160-0366, 7160-0420, 7160-0367, & 7160-0421**

The clam shell assemblies attach to the pillar on the fork truck. They can fit a rectangular pillar from 1 1/2" to 5" wide. The mounts are held in place with 3/8" dia. carriage bolts.

Attach the clam shell assembly to the pillar using the 3/8" carriage bolts and back plate.

7160-0366 & 7160-0420 fit tubes 1 1/2" to 2 1/2" wide.

7160-0367 & 7160-0421 fit tubes 2 1/2" to 5" wide.

The clam shell should be positioned so the top surface of the mount is relatively level. (See figure 1 & 2)

#### Product Mounting Disclaimer

Gamber-Johnson is not liable under any theory of contract or tort law for any loss, damage, personal injury, special, incidental or consequential damages for personal injury or other damage of any nature arising directly or indirectly as a result of the improper installation or use of its products in vehicle or any other application. In order to safely install and use Gamber-Johnson products full consideration of vehicle occupants, vehicle systems (i.e., the location of fuel lines, brakes lines, electrical, drive train or other systems), air-bags and other safety equipment is required. Gamber-Johnson specifically disclaims any responsibility for the improper use or installation of its products not consistent with the original vehicle manufactures specifications and recommendations, Gamber-Johnson product instruction sheets, or workmanship standards as endorsed through the Gamber-Johnson Certified Installer Program.

© Copyright 2017 Gamber-Johnson, LLC

If you need assistance or have questions, call Gamber-Johnson at 1-800-456-6868

**Figure 1. - Example of Clam Shell and Clevis**

**7160-0366 = Full assembly with Small Back Plate**  
**7160-0367 = Full Assembly with Adapter and Large Back Plate**

**NOTE: Position the 3/8 mounting bolts as close to the pillar as possible to prevent bowing the components**

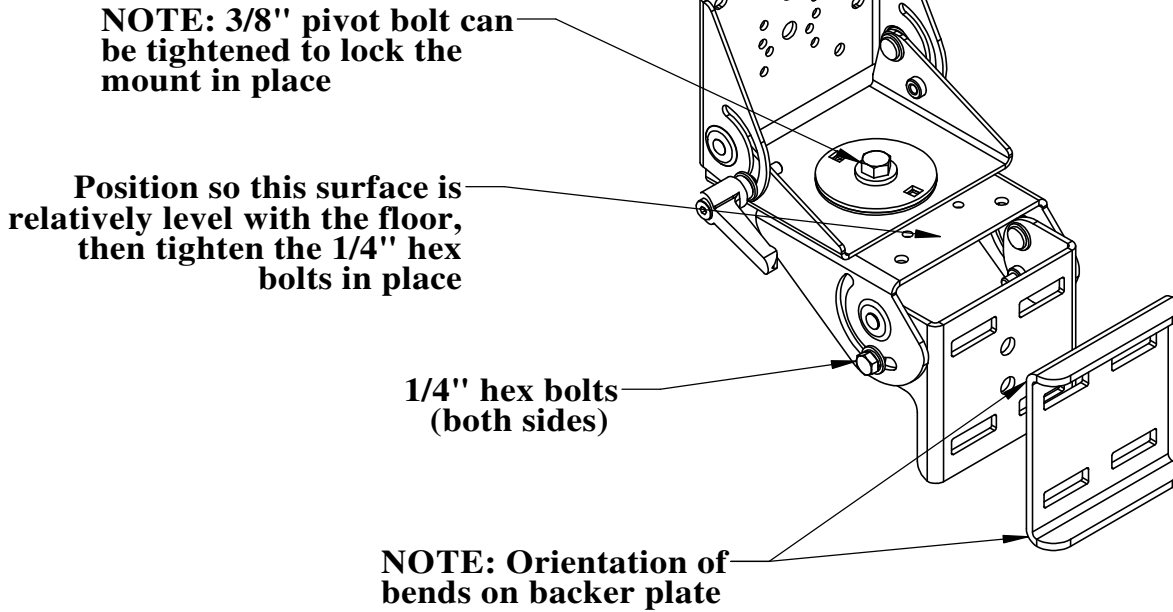

**Figure 1. - Example of Clam Shell with 4" arm and Clevis**

**7160-0420 = Full assembly with Small Back Plate**  
**7160-0421 = Full Assembly with Adapter and Large Back Plate**

**NOTE: Position the 3/8 mounting bolts as close to the pillar as possible to prevent bowing the components**

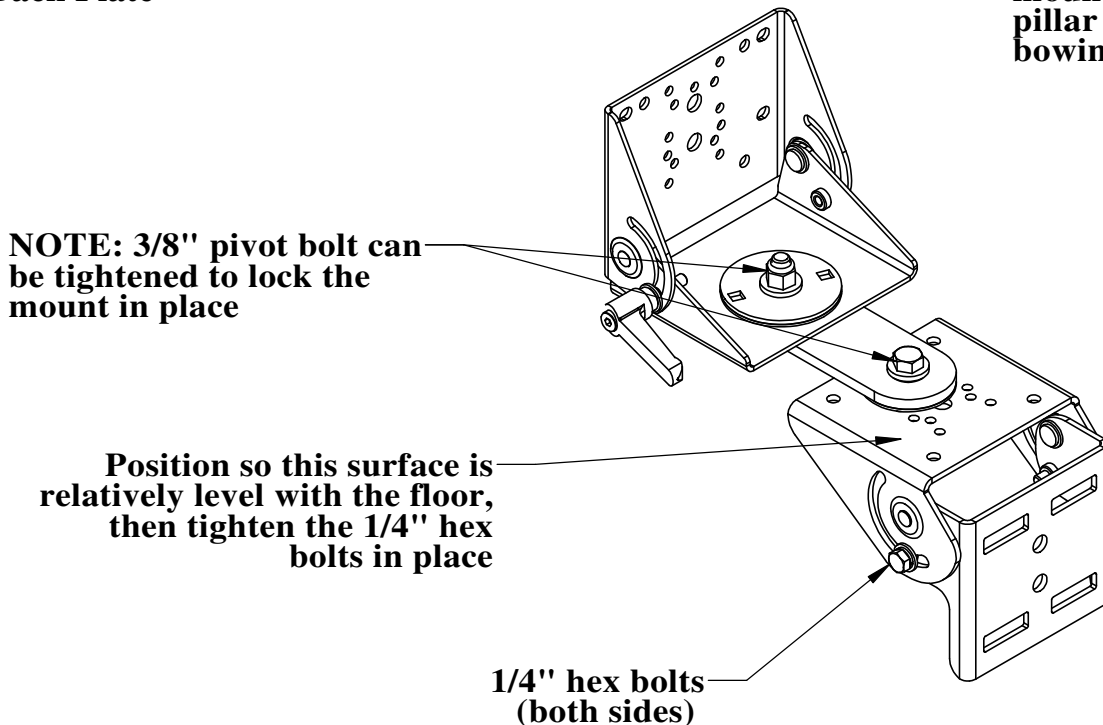

**The components to build a pillar mount can also be purchased separately if required. The hardware to assemble the secondary Clam Shell or 0-90 Clevis to the lower portion are provided with each assembly (7160-0371 or 7160-0356)**

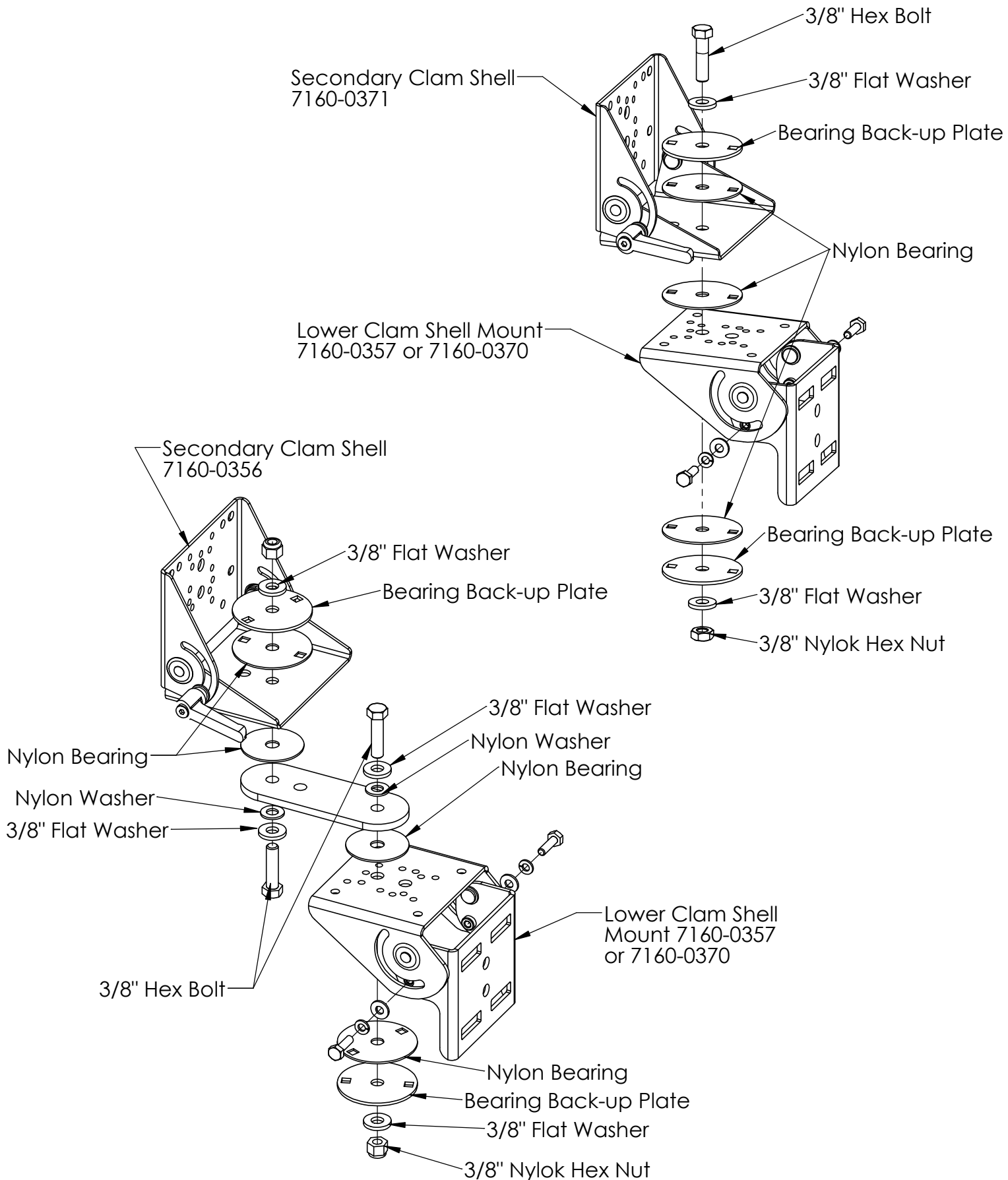

**The Roof Mounts (7160-0368, 7160-0585 & 7160-0586 hang from the upper cage of a fork truck. The mount compresses the cage between the lower portion of the mount and the backplate using 3/8" hardware.**

